

GLF07

Wartungsfreies Flachgleitlager

Self-lubricating slide plate

Similar to: E3176

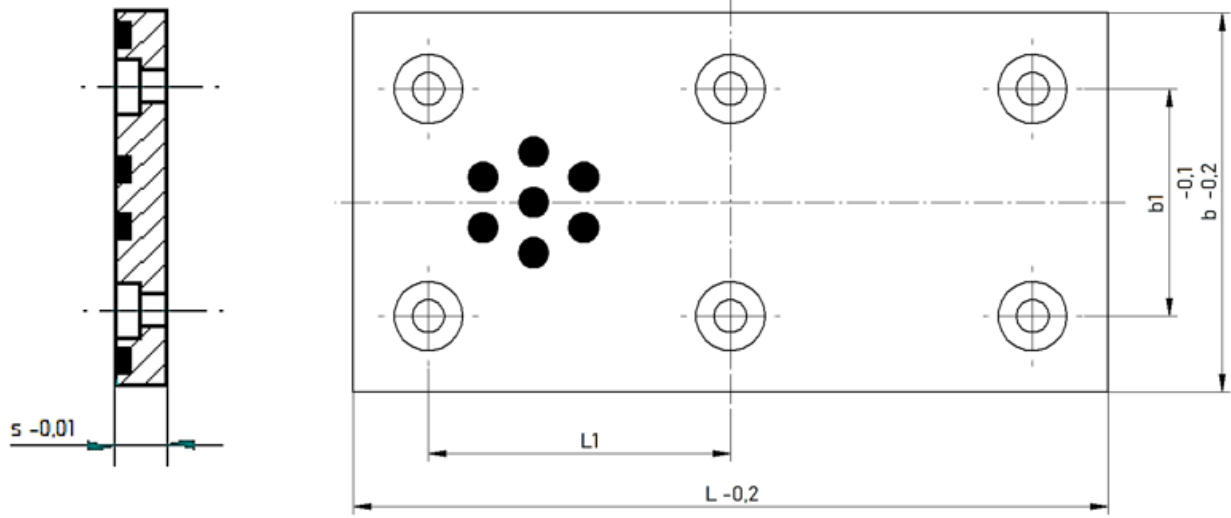

b	s	L	L1	b1	Anzahl Bohrungen	Schrauben DIN 7984	Art.Nr.
12	5	40	24	-	2	M4	GLF07.012.005.040
12	5	50	34	-	2	M4	GLF07.012.005.050
12	5	63	47	-	2	M4	GLF07.012.005.063
12	5	80	32	-	3	M4	GLF07.012.005.080
16	5	40	24	-	2	M4	GLF07.016.005.040
16	5	50	34	-	2	M4	GLF07.016.005.050
16	5	63	47	-	2	M4	GLF07.016.005.063
16	5	80	32	-	3	M4	GLF07.016.005.080
16	5	100	42	-	3	M4	GLF07.016.005.100
16	5	125	67	-	3	M4	GLF07.016.005.125
20	6	40	20	-	2	M5	GLF07.020.006.040
20	6	50	30	-	2	M5	GLF07.020.006.050
20	6	63	43	-	2	M5	GLF07.020.006.063
20	6	80	60	-	2	M5	GLF07.020.006.080
20	6	100	40	-	3	M5	GLF07.020.006.100
25	6	40	20	-	2	M5	GLF07.025.006.040
25	6	50	26	-	2	M5	GLF07.025.006.050
25	6	63	39	-	2	M5	GLF07.025.006.063
25	6	80	56	-	2	M5	GLF07.025.006.080
25	6	100	76	-	2	M5	GLF07.025.006.100
25	6	125	50,5	-	3	M5	GLF07.025.006.125
25	6	160	68	-	3	M5	GLF07.025.006.160
32	6	40	20	-	2	M5	GLF07.032.006.040
32	6	50	26	-	2	M5	GLF07.032.006.050
32	6	63	39	-	2	M5	GLF07.032.006.063
32	6	80	56	-	2	M5	GLF07.032.006.080
32	6	100	76	-	2	M5	GLF07.032.006.100
32	6	125	50,5	-	3	M5	GLF07.032.006.125
32	6	160	68	-	3	M5	GLF07.032.006.160
32	6	200	88	-	3	M5	GLF07.032.006.200

b	s	L	L1	b1	Anzahl Bohrungen	Schrauben DIN 7984	Art.Nr.
40	6	50	26	20	4	M5	GLF07.040.006.050
40	6	63	39	20	4	M5	GLF07.040.006.063
40	6	80	56	20	4	M5	GLF07.040.006.080
40	6	100	76	20	4	M5	GLF07.040.006.100
40	6	125	50,5	20	6	M5	GLF07.040.006.125
40	6	160	68	20	6	M5	GLF07.040.006.160
40	6	200	58	20	8	M5	GLF07.040.006.200
50	8	63	39	24	4	M6	GLF07.050.008.063
50	8	80	56	24	4	M6	GLF07.050.008.080
50	8	100	76	24	4	M6	GLF07.050.008.100
50	8	125	50,5	24	6	M6	GLF07.050.008.125
50	8	160	68	24	6	M6	GLF07.050.008.160
50	8	200	58	24	8	M6	GLF07.050.008.200
50	8	250	74	24	8	M6	GLF07.050.008.250
63	8	80	56	35	4	M6	GLF07.063.008.080
63	8	100	76	35	4	M6	GLF07.063.008.100
63	8	125	50,5	35	6	M6	GLF07.063.008.125
63	8	160	68	35	6	M6	GLF07.063.008.160
63	8	200	58	35	8	M6	GLF07.063.008.200
80	8	100	76	50	4	M6	GLF07.080.008.100
80	8	125	50,5	50	6	M6	GLF07.080.008.125
80	8	160	68	50	6	M6	GLF07.080.008.160
80	8	200	58	50	8	M6	GLF07.080.008.200
80	8	250	72	50	8	M6	GLF07.080.008.250
80	8	315	93	50	8	M6	GLF07.080.008.315